



King Henrys Reach, Manbre Road,  
, W6

£750 Per Week,

NAPIER WATT

T: 0207 935 0011  
E: [enquiries@napierwatt.co.uk](mailto:enquiries@napierwatt.co.uk)  
W: [napierwatt.co.uk](http://napierwatt.co.uk)

---

35 Berkeley Square, Mayfair, London, W1J 5BF











## Description

A spacious, light, and airy two double bedroom flat based in the gated development of King Henry's Reach. This fourth floor apartment (with lift) of approximately 1,080sq ft comprises a master en-suite, second bedroom, family bathroom, kitchen and bright living room leading onto a fantastic south-western facing terrace with uninterrupted views over the Thames. This private and peaceful portered building is ideally located along the river whilst being walking distance from all the amenities and transport links of Hammersmith. The apartment also benefits from secure allocated parking.

Entrance Hall : 2 Bedrooms : 2 Bathrooms : Reception Room : Kitchen : Terrace : EPC B : Council Tax Band G

## Key Features

- STUNNING RIVER VIEWS
- PORTER
- LIFT
- BALCONY

## Terms

Fees & Charges: Tenancies exceeding £100,000 Per annum £480 inc Vat, Tenancies where a company is a tenant £480 Inc Vat.

## King Henry's Reach

Approx. Gross Internal Area 1080 Sq Ft - 100.34 Sq M

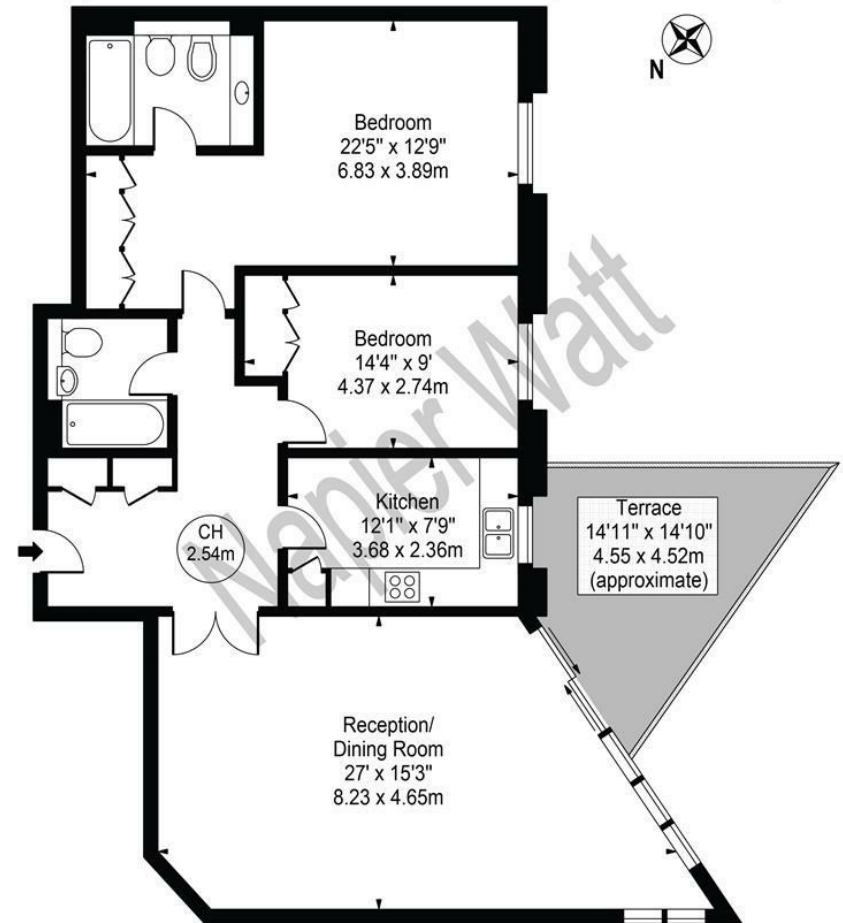

Fourth Floor

For Illustration Purposes Only - Not To Scale

This floor plan should be used as a general outline for guidance only and does not constitute in whole or in part an offer or contract. Any intending purchaser or lessee should satisfy themselves by inspection, searches, enquiries and full survey as to the correctness of each statement. Any areas, measurements or distances quoted are approximate and should not be used to value a property or be the basis of any sale or let.

IMPORTANT: We would inform prospective purchasers that these sales particulars have been prepared as a general guide only. A detailed survey has not been carried out, nor the services, appliances and fittings tested. Room sizes should not be relied upon for furnishing purposes and are approximate. If floor plans are included, they are for guidance only and illustration purposes only and may not be to scale. If there are any important matters likely to affect your decision to buy, please contact us before viewing the property.